

QR Ladybird V2 User Manual

1.0 DEVO-F4 transmitter setup

1.1 Boost Screen

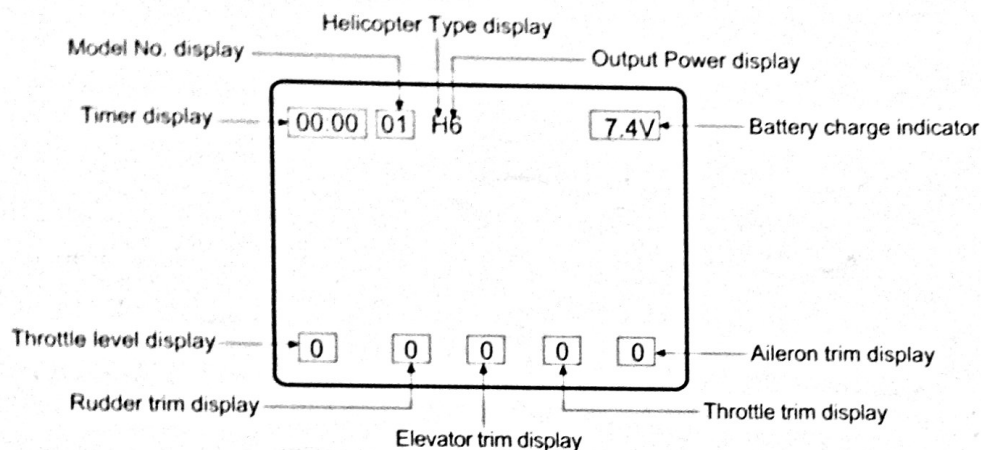

1.2 Type Select

Press ENT to the Main Menu. Press UP or DN to move the cursor → to point to Model Menu, press ENT to Model Menu; Press UP or DN to move the cursor → to point to Type Select, press ENT to Type Select setting interface; Press UP or DN to move the cursor → to point to Helicopter option. Press ENT to confirm and then press EXT to return to Model Menu.

1.3 Model Select

Under Model Menu interface, press ENT to the Main Menu. Press UP or DN to move the cursor → to point to Model Select, press ENT to Model Select; Press UP or DN to move the cursor → to point to desired option. Press ENT to confirm and then press EXT to return to Model Menu.

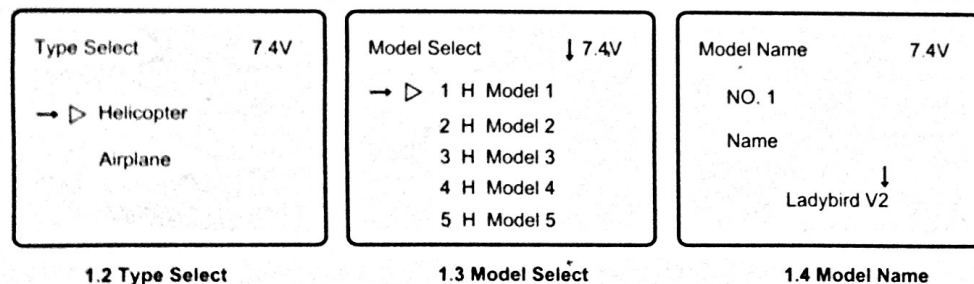

1.4 Model Name

Under the Model Menu interface, press UP or DN to move the cursor → to point to Model Name, press ENT to Model Name setting interface; press UP or DN to move the cursor → to point to select the character and figure which need to be changed, press R or L button to change the character and figure, name model as Ladybird V2. Press ENT to confirm and then press EXT to return to Main Menu.

1.5 Reverse Switch

Press ENT to the Main Menu. Press UP or DN to move the cursor → to point to Function Menu, press ENT to Function Menu; Press UP or DN to move the cursor → to point to Reverse Switch, press ENT to Reverse Switch setting interface; Press UP or DN to move the cursor → to point to desired option, press R or L to change the status between Normal and Reverse. Please see the right illustration. Press ENT to confirm and then press EXT to exit.

Reverse Switch		7.4V
→ Elevator	Normal	
Aileron	Normal	
Throttle	Normal	
Rudder	Normal	

1.6 Video Select

Press ENT to the Main Menu. Press UP or DN to move the cursor → to point to System Menu, press ENT to System Menu; Press UP or DN to move the cursor → to point to Video Select, press ENT to Video Select setting interface. Press R or L to select Active. Press DN to move the cursor → to point to Channel item, press R or L to make the Number change between 1 and 8. With the TX5805 Transmitting channel, 1-8 channels could be chosen to receive the image signal. Press ENT to confirm and then press EXT to exit.

Video Select		7.4V
→ Status	Active	
Channel	1/8	

1.7 TX5805 Transmitting channel selection

There are 8 different channels can be selected. You can choose the best frequency channel according to the image quality like follows(The right code switch 2 is idle):

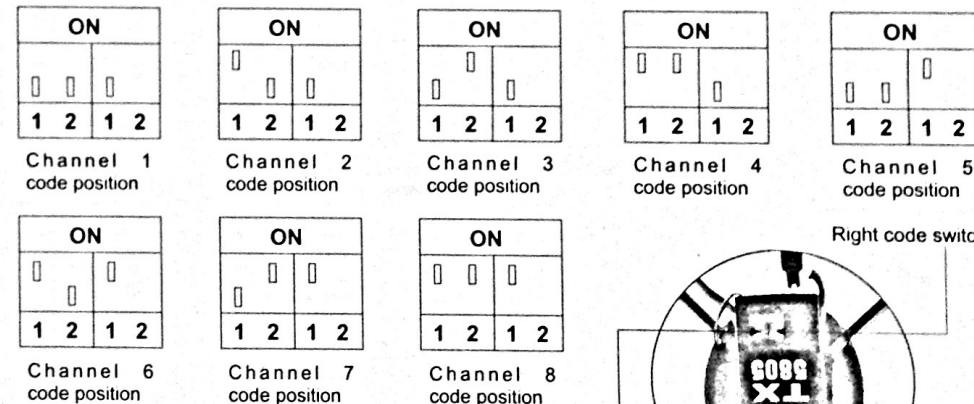

Remark:

1. TX5805 channel is corresponding to the video receive channel.

2.0 Additional Instruction

- (1) The front propellers are in black color while the rear propellers are in Orange.
- (2) After connecting the power of the QR Ladybird V2, please check the propellers rotation direction, X front/ X back propellers rotate CW, Y front/ Y back propellers rotate CCW.
- (3) You can adjust the radio trim button (except the throttle trim) if the quadcopter flight drift.

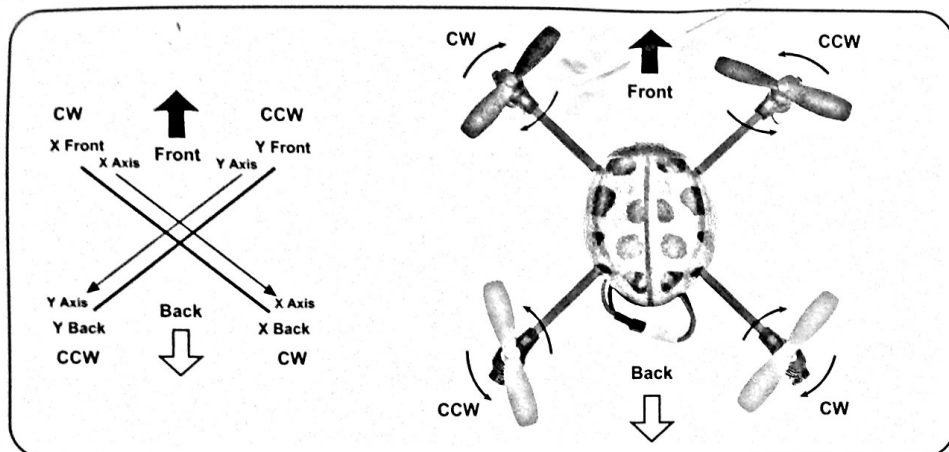

3.0 Setup of the RX2643H-D receiver

3.1 RX2643H-D receiver features

- (1) Receiver RX2643H-D adopts 2.4G spread spectrum technology with the functions of automatic scanning, code pairing and LED receiving indication.
- (2) Integrated design of 3-Axis gyro and abitude control provides precise locating in air.

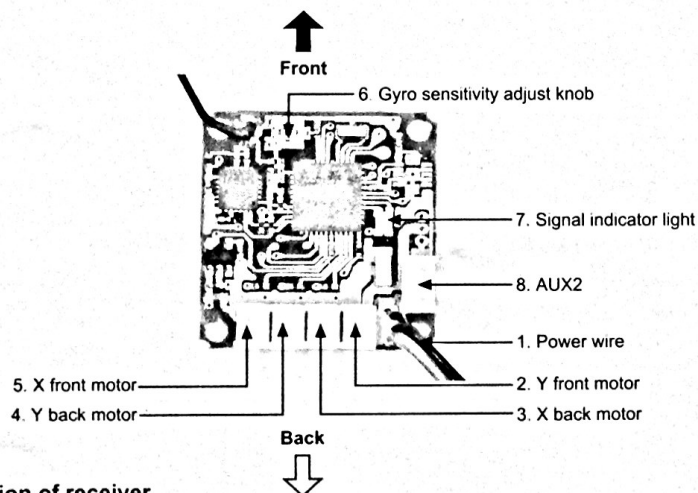

3.2 Function of receiver

S/N	Name for short	Full name	Function
1	Power wire	Connect to the lipo battery.	
2	Y front motor	Connect to the Y front motor wire.	Terminal is facing right.
3	X back motor	Connect to the X back motor wire.	Terminal is facing right.
4	Y back motor	Connect to the Y back motor wire.	Terminal is facing right.

5	X front motor	Connect to the X front motor wire.	Terminal is facing right.
6	Gyro sensitivity adjust knob	Adjust the gyro sensitivity of the front/back /left/right /tail.	
7	Signal indicator light	Show the bind status.	
8	AUX2	Connect to the TX5805 transmitting signal wire or plug in the bind plug to clear ID memory.	Terminal is facing left.

3.3 Flight Modes switches of the Receiver

Note:Please strictly refer to below operations.

- (1) Pull the throttle stick to the lowest position, turn on the radio and connect the UFO battery, then comes to the code pairing status. Turn off the UFO battery after code pairing successfully. Then push the throttle stick to the top position and connect the UFO battery, then comes to the code pairing status again. The receiver indicator will flash between red and green alternately after code pairing successfully. That's the flight mode switch status.

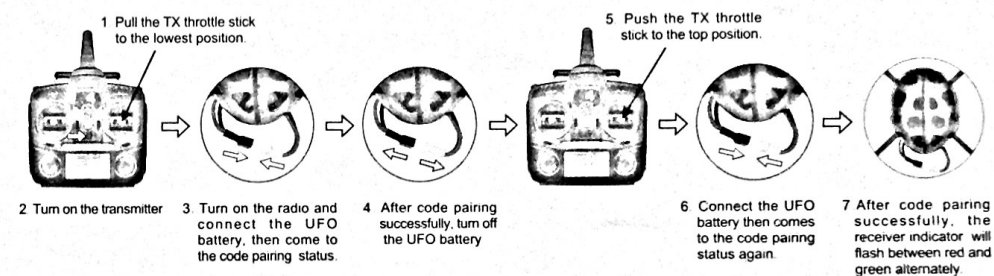

- (2) In Flight Mode switch status, push and pull the Elevator Stick up and down four times or above to change the Flight Mode(Finish within 2 seconds). It is in Normal Flight mode when the red indicator turns solid, and it's in Roll Flight mode when the green indicator turns solid.

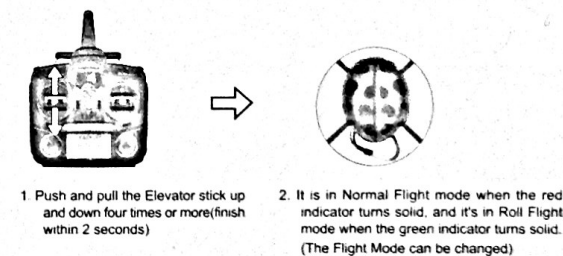

- (3) After choose the Flight Mode, push the throttle stick at the lowest position, then flight available.

3.4 Adjustment of receiver

- (1) Receiver LED indicator: Quick flashing indicates the reception of a new signal; a solid light means connection is completed successfully; slow flashing indicates failure to receive a signal, please disconnect and reconnect the battery.
- (2) Adjust knob of the gyro: CW rotating increase the sensitivity of the Gyro, CCW rotating decrease the sensitivity of the Gyro. The default setting is Middle,generally there is no need to trim.
- (3) Clear fix ID in receiver: Insert plug terminal into AUX2 channel on receiver to clear fix ID memory and disconnect plug terminal when the indicator on receiver start to flash.